

Job Name: Park Place Christian – Elmhurst, Illinois

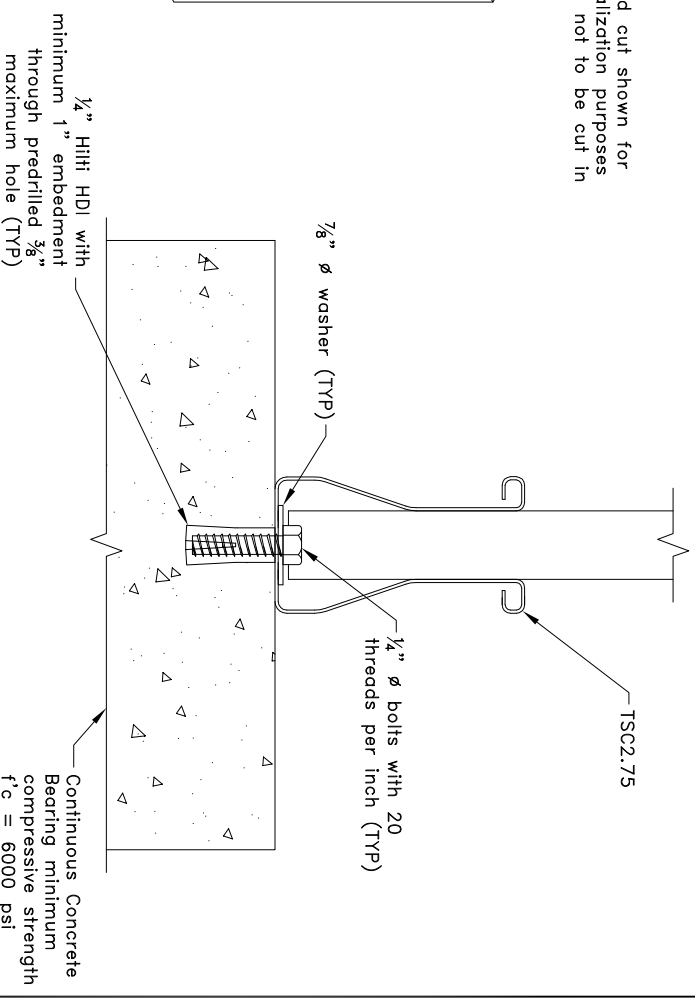
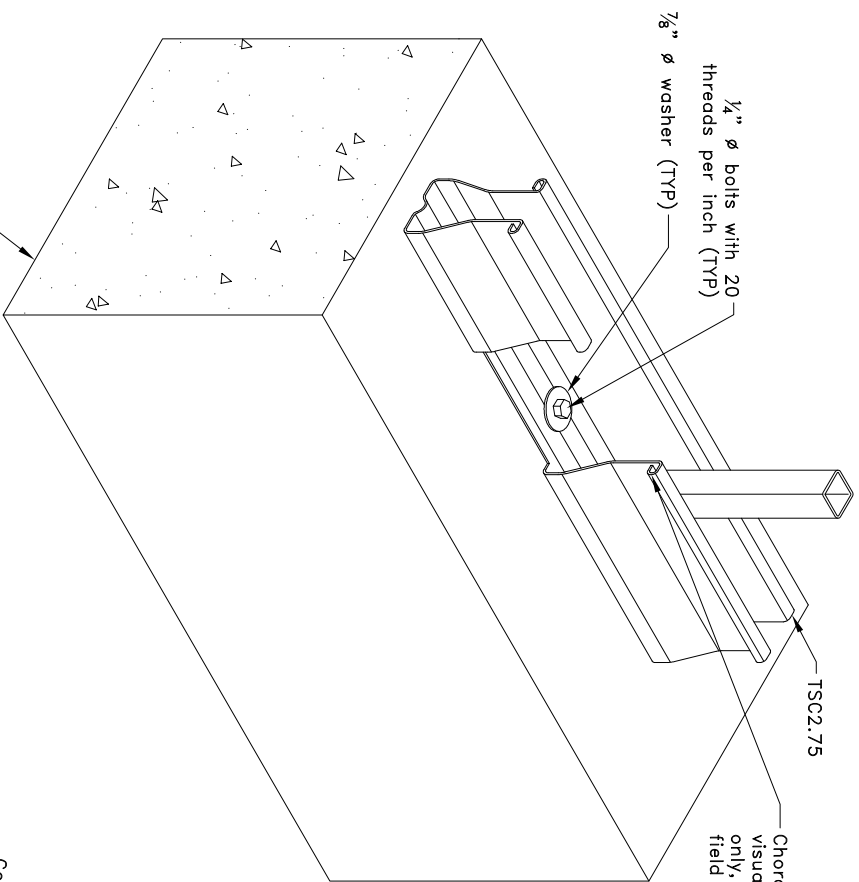

U = 250 # MAX

General Notes:

1. Hilti HDI to be installed within 2" of panel point.
2. Detail only valid when referenced on an ITW-TrusSteel Truss component drawing sealed by a registered design Professional.
3. Refer to manufacturer's publications regarding proper installation of anchors.
4. Anchor is not to be installed until the concrete has reached the specified design strength. Refer to manufacturer's code approval regarding proper installation of anchor.
5. U refers to uplift.
6. It is the responsibility of the building designer to verify that the structural support members are designed for all applicable loads including (but not limited to) the loads given on this detail.
7. Cold-Formed Steel calculations are per the 2010 supplement to the AISI 2007 "North American Specification for the Design of Cold-Formed Steel Structural Members" (S100-07/S2-10).

TrusSteel
An ITW Company

www.TrusSteel.com

Florida: 1950 Malety Drive / Haines City, FL 33844 / (800) 755-6001
Missouri: 13389 Lakefront Drive / Earth City, MO 63045 / (800) 326-4102
California: 8351 Rovana Circle / Sacramento, CA 95828 / (800) 877-3678

Hilti HDI Uplift Attachment to Concrete

ITW Building Components Group, Inc. shall not be responsible for any performance failure in a connection due to a deviation from this detail. Any variation from this detail shall be approved in advance by ITW Building Components Group, Inc.

Custom Detail:

TS-CD-TB-C1-002

Date:

10/20/10

Custom Detail:

Truss to Bearing